

Thank you for choosing the SUSOL Contactor and Overload Relay.  
Please read this instruction manual carefully for proper and safe usage.  
The instruction manual should be given to the person who actually uses the products and is responsible for their maintenance.



Warning

- 1) Before installation or inspection of sequence, please make sure to turn off the upstream circuit breakers.
- 2) Be sure to tighten the terminal screws to the torque specified in the instruction manual, otherwise fire may be occurred due to temperature rise.
- 3) Do not modify the device unless it is permitted.
- 4) Do not use the product after removing its arc-extinguishing chamber, electric shock or burns may be resulted in.
- 5) After the power interruption of coil for magnetic contactor caused by a trip operation of overload relays, please make sure to remove the cause and reset operation.
- 6) Installation maintenance and inspection should be performed by qualified engineers having special knowledge.

### Check point before Installation







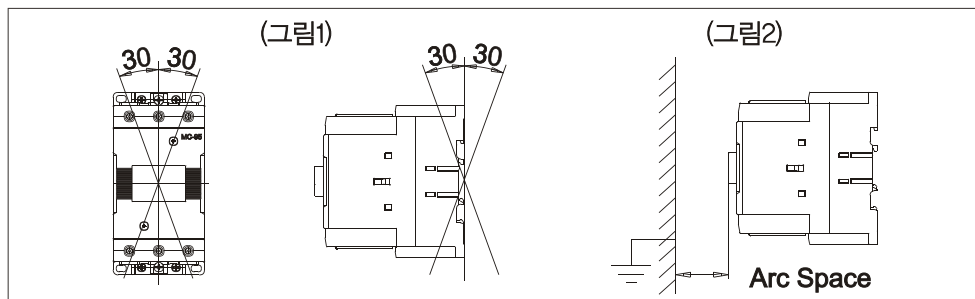







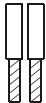





Please check whether the product meets the rated capacity, voltage, current and frequency for the load.

### Handling Instruction

- 1) Install onto the place where it is free vibration and humidity.
- 2) It is normal to set contactor upright to panel but it is possible to set contactor with an inclination of 30 degrees to panel in case of Fig.1
- 3) Keep the arc space distance as 0mm with MC-9~95 in panel shown in Fig.2 when installing magnetic contactor.



### Size of Wire and Tightening Torque

FRAME \ WIRE TYPE									Torque
		(mm <sup>2</sup> / AWG)							
MC-32		1~6/18~10		1~6/18~10		1~6/18~10	0.75~4 /18~10	1.25~5.5	0.8~2.5 /7~22
MC-63		0.75~35 /18~2	0.75~25 /18~4	0.75~35 /18~2	0.75~25 /18~4	0.75~25 /18~4	0.75~16 /18~6		3~4.5 /26~39
								2~22	
MC-95		2.5~70 /12~2_0	2.5~50 /12~1_0	2.5~70 /12~2_0	2.5~50 /12~1_0	2.5~50 /12~1_0	2.5~35 /10~2		4~6 /35~53
								2~38	
COIL TER.		0.5~2.5/20~14			1.25~2			1.25~3.5	12[Kgfl.cm]

### Thermal Overload Relay

- 1) Open the safety cover and set the full load current value of motor by rotating the triangle point.
- 2) Please rotate the current adjustment dial within the range of arrow.
- 3) In the manual reset mode, reset operation can be achieved by pushing the reset button, and to change from the manual reset-mode to automatic reset mode turn the adjustment dial to the left while depressing the reset button and then fix the arrow to the automatic reset mode(A).
- 4) Push the red button for stopping and pull it for testing.

	STOP	TEST/TRIP	RESET
NC 95~96			
NO 97~98			

### Caution of reversing Contactors and Switches

- 1) In case of forward & reverse operation of motor using 2 contactor(switches) Please use the reversible magnetic contactor(switches) : R-type
- 2) In case of using in electric reversible mode which may cause arc short by sudden change, recommend to use the relay.

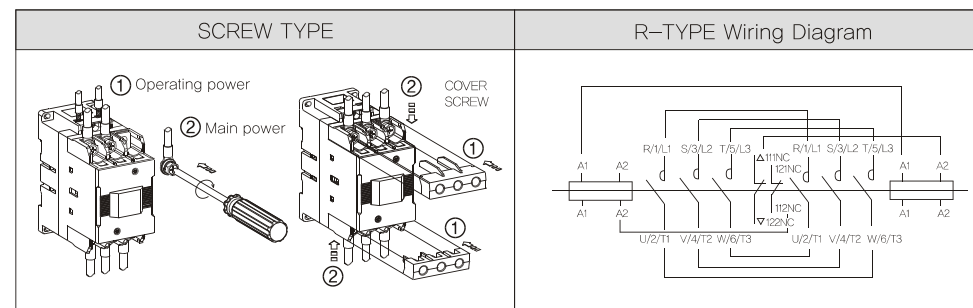
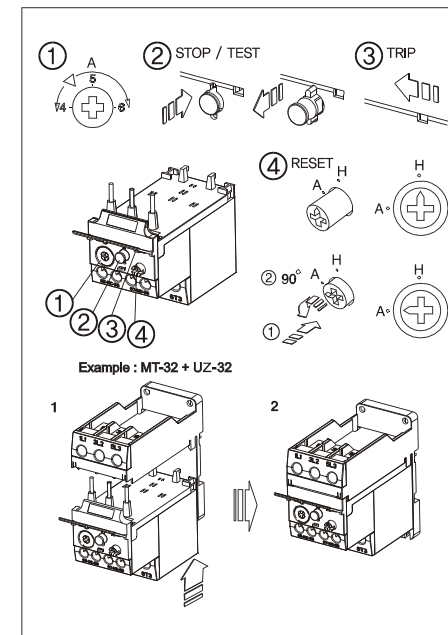

### HEAD OFFICE

Yonsei Jaedan Severance bldg. 84-11, 5-ka Namdaemun-ro Chung-Ku Seoul, Korea.

**LS Industrial Systems**

### Service Center

TEL : 82 - 43 - 276 - 6075  
FAX : 82 - 43 - 276 - 6076  
www.lsis.biz

### Head office

TEL : 82) 2 - 2034 - 4870  
FAX : 82) 2 - 2034 - 4713  
www.lsis.biz

### MC-9,12,18,25,32,35,40,50,63,65,75,85,95

Example: MC-32

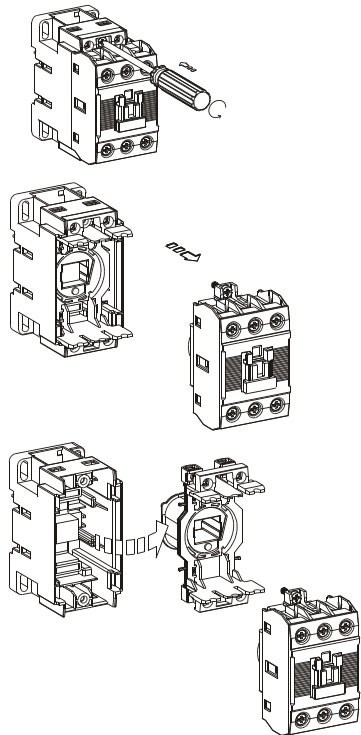

DRILLING TEMPLATE

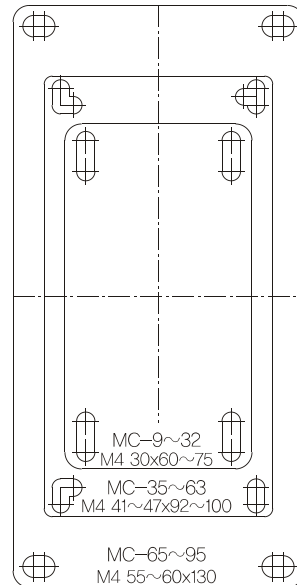

COIL 1) Use suitably the allowable voltage range of operating coil

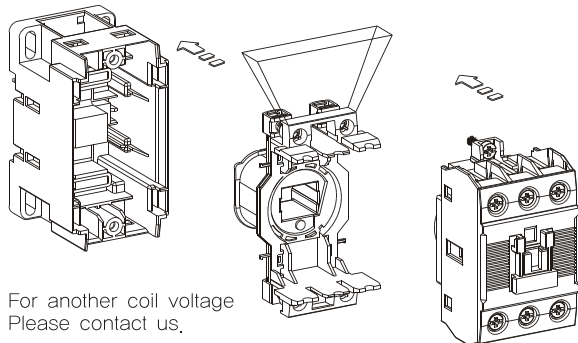

50Hz	60Hz
24V	24V
42V	48V
48V	110V
110V	120V
220V	220V
240V	240V
380V	380V
400V	440V
440V	480V
500V	500V
550V	

### MC-9,12,18,25,32,35,40,50,63,65,75,85,95

ACCESSORIES

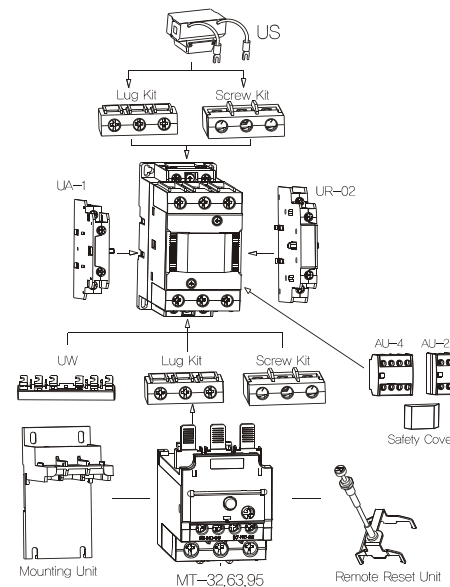

UA-1, UR-02

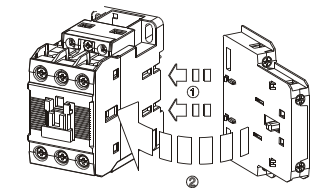

After lifting adhesion,  
assemble the hole of crossbar exactly.

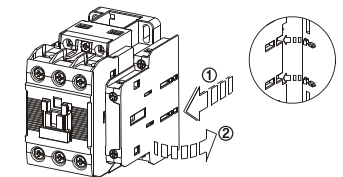

After lifting up the upper piece ①,  
you can separate it to push outer side ②

US(Surge Unit)

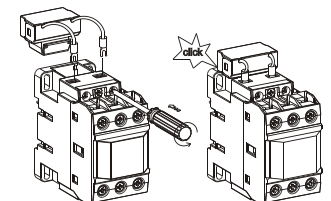

AL-9.50.95 AU-2,4



LINE

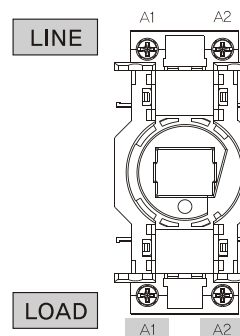

	A1	A2	A1	A2
A1				
A2				
A1				
A2				